

ANCESTORS OF _____

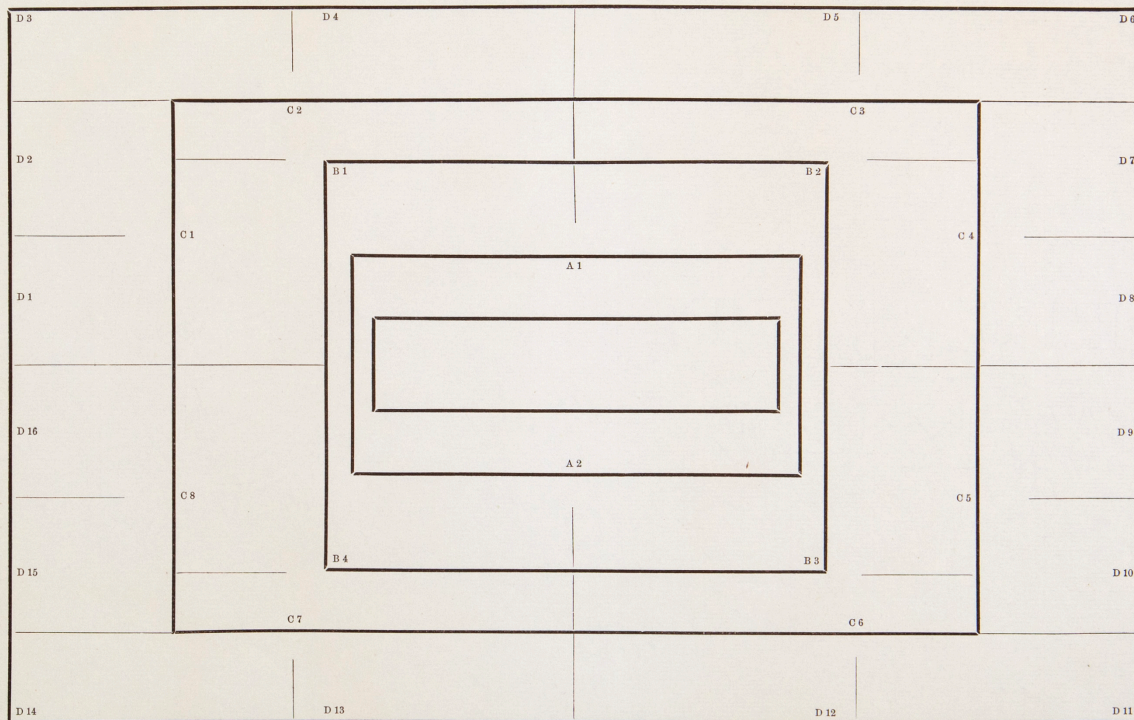

Odd numbers indicate males (fathers, grandfathers, &c.)
 EVEN " " females (mothers, grandmothers, &c.)

A = Father (A 1) and Mother (A 2)

B = { Grandfathers (B 1 father's father)
 and (B 3 mother's father)
 Grandmothers (B 2 father's mother)
 (B 4 mother's mother)

C = { Great-grandfathers (C 1 father's father's father)
 (C 3 father's mother's father)
 (C 5 father's father's father)
 (C 7 mother's mother's father)
 and
 Great-grandmothers (C 2 father's father's mother)
 (C 4 father's mother's mother)
 (C 6 mother's father's mother)
 (C 8 mother's mother's mother)

D = { Great-great-grandfathers and Great-great-grandmothers
 (D 1 father's father's father's father) (D 2 father's father's father's mother)
 (D 3 father's father's mother's father) (D 4 father's father's mother's mother)
 (D 5 father's mother's father's father) (D 6 father's mother's father's mother)
 (D 7 father's mother's mother's father) (D 8 father's mother's mother's mother)
 (D 9 mother's father's father's father) (D 10 mother's father's father's mother)
 (D 11 mother's father's mother's father) (D 12 mother's father's mother's mother)
 (D 13 mother's mother's father's father) (D 14 mother's mother's father's mother)
 (D 15 mother's mother's mother's father) (D 16 mother's mother's mother's mother)

ANCESTORS
of Gantarrin and the
the children of the

BC 2151 E1.2.4.1

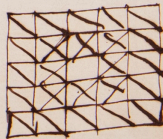
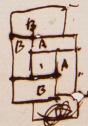

ANCESTORS

OF Tsho'ice (Cone to) & his
wife Tsain-ai

BC 151 61.2.4.2



ANCESTORS

OF Khanruu (Sopu)
& his wife.

BC 151 E1.2.4.3



BC 151 E12-4-4



The Bottom of Mars!
 letters with Judge [unclear]



BC 151 E1.2.4.5

[illegible]

ANCESTORS
of the
first
settlers



ANCESTORS of H. K. B. H. N. Y. (G. B. B. B. B.)

Odd numbers indicate males (father, grandfather, etc.)
Even numbers indicate females (mother, grandmother, etc.)

A = { Father (A1)
Mother (A2)

Male reversed

BC 151 E 12.47

B = { Grandfather (B1 father's father)
& (B2 mother's father)
Grandmother (B3 father's mother)
(B4 mother's mother)

A1 brother of
maternal
(S. L. L. L. L.)

Ab.
G. B. B. B. B.
(G. B. B. B. B.)
Ancester
and
separate
Diagram

C = { Greatgrandfather
(C1 father's father's father)
(C2 father's mother's father)
(C3 mother's father's father)
(C4 mother's mother's father)
&
Greatgrandmother
(C5 father's father's mother)
(C6 father's mother's mother)
(C7 mother's father's mother)
(C8 mother's mother's mother)





DIAGRAM showing the ancestors
of the *kh'bleu* (Korduan) / *kh'bu* / *kh'bu*
ODD numbers indicate males
(father, grandfathers, etc.)

EVEN numbers indicate females
(mother, grandmothers, etc.)

A = { Father (A1)
&
Mother (A2)



BC151 E12-4-8

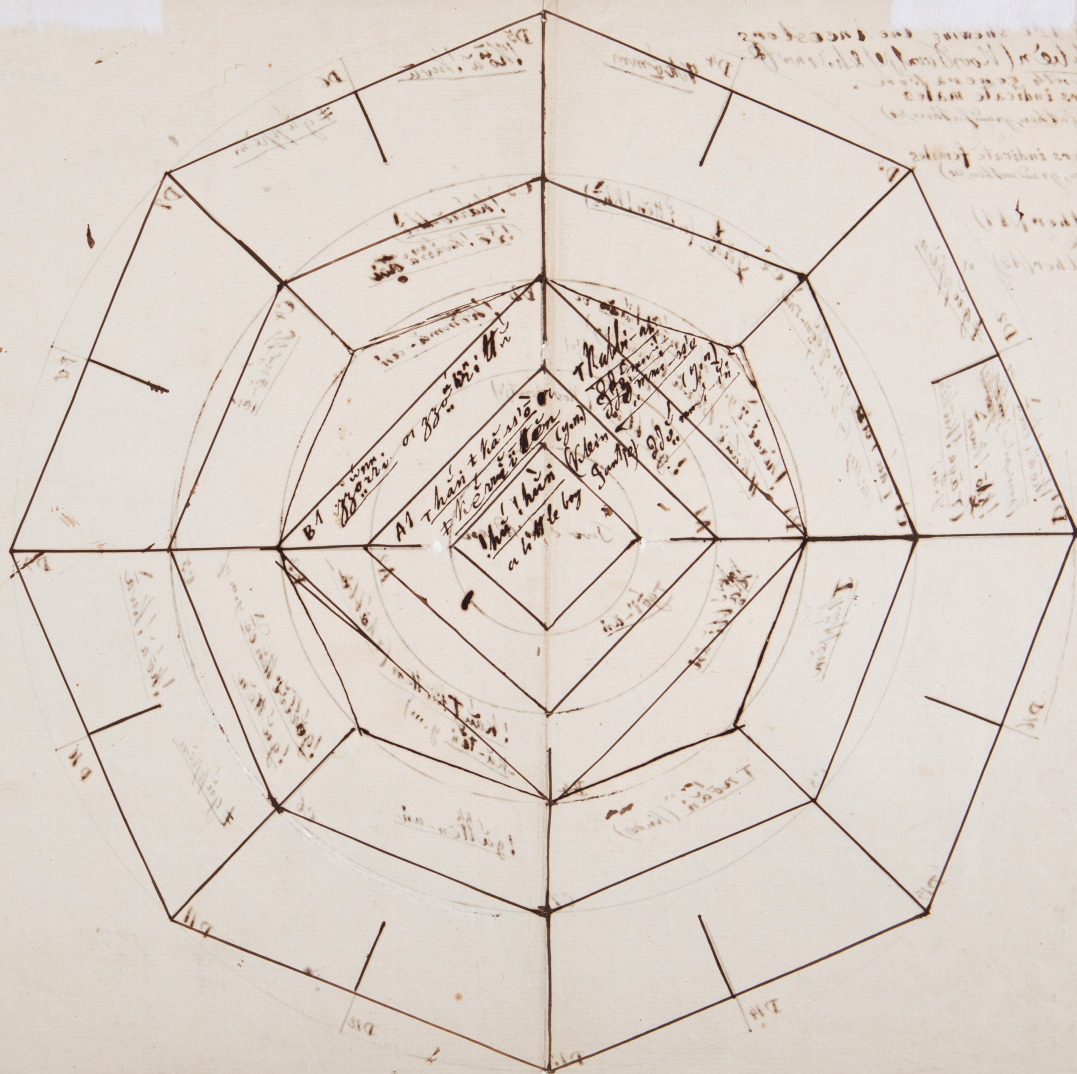

ANCESTORS

or Utham Kasso (Wahot, No.
 & Utham Kasso (Wahot, No.
 & Utham Kasso (Wahot, No.
 & Utham Kasso (Wahot, No.)

BC151 E12-4-9

D16	D1	D2	D3	D4
<u>guppēm</u>				
	<u>g8</u>	<u>C1</u> <u>stāw</u> <u>hē</u> <u>y. n. of</u> <u>g2</u> <u>hābē</u>		<u>D5</u>
<u>D15</u> <u>m</u> <u>hōa</u> <u>hwa</u> <u>hōa</u> <u>hwa</u> <u>tāg</u> <u>hōka</u>		<u>B4</u> <u>m</u> <u>hōa</u> <u>hwa</u> <u>tāg</u> <u>hōka</u>	<u>B3</u> <u>m</u> <u>hōa</u> <u>hwa</u> <u>tāg</u> <u>hōka</u>	<u>D5</u> <u>m</u> <u>hōa</u> <u>hwa</u> <u>tāg</u> <u>hōka</u>
<u>D14</u> <u>m</u> <u>g8</u>	<u>C7</u> <u>hōa</u> <u>hwa</u> <u>tāg</u> <u>hōka</u>	<u>B4</u> <u>m</u> <u>hōa</u> <u>hwa</u> <u>tāg</u> <u>hōka</u>	<u>B3</u> <u>m</u> <u>hōa</u> <u>hwa</u> <u>tāg</u> <u>hōka</u>	<u>D5</u> <u>m</u> <u>hōa</u> <u>hwa</u> <u>tāg</u> <u>hōka</u>
<u>B13</u> <u>m</u> <u>hōa</u> <u>hwa</u> <u>tāg</u> <u>hōka</u>	<u>C6</u> <u>hōa</u> <u>hwa</u> <u>tāg</u> <u>hōka</u>	<u>B4</u> <u>m</u> <u>hōa</u> <u>hwa</u> <u>tāg</u> <u>hōka</u>	<u>B3</u> <u>m</u> <u>hōa</u> <u>hwa</u> <u>tāg</u> <u>hōka</u>	<u>D5</u> <u>m</u> <u>hōa</u> <u>hwa</u> <u>tāg</u> <u>hōka</u>
<u>D12</u> <u>m</u> <u>hōa</u> <u>hwa</u> <u>tāg</u> <u>hōka</u>	<u>C6</u> <u>hōa</u> <u>hwa</u> <u>tāg</u> <u>hōka</u>	<u>B4</u> <u>m</u> <u>hōa</u> <u>hwa</u> <u>tāg</u> <u>hōka</u>	<u>B3</u> <u>m</u> <u>hōa</u> <u>hwa</u> <u>tāg</u> <u>hōka</u>	<u>D5</u> <u>m</u> <u>hōa</u> <u>hwa</u> <u>tāg</u> <u>hōka</u>
<u>D11</u> <u>m</u> <u>hōa</u> <u>hwa</u> <u>tāg</u> <u>hōka</u>	<u>C6</u> <u>hōa</u> <u>hwa</u> <u>tāg</u> <u>hōka</u>	<u>B4</u> <u>m</u> <u>hōa</u> <u>hwa</u> <u>tāg</u> <u>hōka</u>	<u>B3</u> <u>m</u> <u>hōa</u> <u>hwa</u> <u>tāg</u> <u>hōka</u>	<u>D5</u> <u>m</u> <u>hōa</u> <u>hwa</u> <u>tāg</u> <u>hōka</u>
<u>D10</u> <u>m</u> <u>hōa</u> <u>hwa</u> <u>tāg</u> <u>hōka</u>	<u>C6</u> <u>hōa</u> <u>hwa</u> <u>tāg</u> <u>hōka</u>	<u>B4</u> <u>m</u> <u>hōa</u> <u>hwa</u> <u>tāg</u> <u>hōka</u>	<u>B3</u> <u>m</u> <u>hōa</u> <u>hwa</u> <u>tāg</u> <u>hōka</u>	<u>D5</u> <u>m</u> <u>hōa</u> <u>hwa</u> <u>tāg</u> <u>hōka</u>
<u>D9</u> <u>m</u> <u>hōa</u> <u>hwa</u> <u>tāg</u> <u>hōka</u>	<u>C6</u> <u>hōa</u> <u>hwa</u> <u>tāg</u> <u>hōka</u>	<u>B4</u> <u>m</u> <u>hōa</u> <u>hwa</u> <u>tāg</u> <u>hōka</u>	<u>B3</u> <u>m</u> <u>hōa</u> <u>hwa</u> <u>tāg</u> <u>hōka</u>	<u>D5</u> <u>m</u> <u>hōa</u> <u>hwa</u> <u>tāg</u> <u>hōka</u>
<u>D8</u> <u>m</u> <u>hōa</u> <u>hwa</u> <u>tāg</u> <u>hōka</u>	<u>C6</u> <u>hōa</u> <u>hwa</u> <u>tāg</u> <u>hōka</u>	<u>B4</u> <u>m</u> <u>hōa</u> <u>hwa</u> <u>tāg</u> <u>hōka</u>	<u>B3</u> <u>m</u> <u>hōa</u> <u>hwa</u> <u>tāg</u> <u>hōka</u>	<u>D5</u> <u>m</u> <u>hōa</u> <u>hwa</u> <u>tāg</u> <u>hōka</u>
<u>D7</u> <u>m</u> <u>hōa</u> <u>hwa</u> <u>tāg</u> <u>hōka</u>	<u>C6</u> <u>hōa</u> <u>hwa</u> <u>tāg</u> <u>hōka</u>	<u>B4</u> <u>m</u> <u>hōa</u> <u>hwa</u> <u>tāg</u> <u>hōka</u>	<u>B3</u> <u>m</u> <u>hōa</u> <u>hwa</u> <u>tāg</u> <u>hōka</u>	<u>D5</u> <u>m</u> <u>hōa</u> <u>hwa</u> <u>tāg</u> <u>hōka</u>
<u>D6</u> <u>m</u> <u>hōa</u> <u>hwa</u> <u>tāg</u> <u>hōka</u>	<u>C6</u> <u>hōa</u> <u>hwa</u> <u>tāg</u> <u>hōka</u>	<u>B4</u> <u>m</u> <u>hōa</u> <u>hwa</u> <u>tāg</u> <u>hōka</u>	<u>B3</u> <u>m</u> <u>hōa</u> <u>hwa</u> <u>tāg</u> <u>hōka</u>	<u>D5</u> <u>m</u> <u>hōa</u> <u>hwa</u> <u>tāg</u> <u>hōka</u>
<u>D5</u> <u>m</u> <u>hōa</u> <u>hwa</u> <u>tāg</u> <u>hōka</u>	<u>C6</u> <u>hōa</u> <u>hwa</u> <u>tāg</u> <u>hōka</u>	<u>B4</u> <u>m</u> <u>hōa</u> <u>hwa</u> <u>tāg</u> <u>hōka</u>	<u>B3</u> <u>m</u> <u>hōa</u> <u>hwa</u> <u>tāg</u> <u>hōka</u>	<u>D5</u> <u>m</u> <u>hōa</u> <u>hwa</u> <u>tāg</u> <u>hōka</u>
<u>D4</u> <u>m</u> <u>hōa</u> <u>hwa</u> <u>tāg</u> <u>hōka</u>	<u>C6</u> <u>hōa</u> <u>hwa</u> <u>tāg</u> <u>hōka</u>	<u>B4</u> <u>m</u> <u>hōa</u> <u>hwa</u> <u>tāg</u> <u>hōka</u>	<u>B3</u> <u>m</u> <u>hōa</u> <u>hwa</u> <u>tāg</u> <u>hōka</u>	<u>D5</u> <u>m</u> <u>hōa</u> <u>hwa</u> <u>tāg</u> <u>hōka</u>
<u>D3</u> <u>m</u> <u>hōa</u> <u>hwa</u> <u>tāg</u> <u>hōka</u>	<u>C6</u> <u>hōa</u> <u>hwa</u> <u>tāg</u> <u>hōka</u>	<u>B4</u> <u>m</u> <u>hōa</u> <u>hwa</u> <u>tāg</u> <u>hōka</u>	<u>B3</u> <u>m</u> <u>hōa</u> <u>hwa</u> <u>tāg</u> <u>hōka</u>	<u>D5</u> <u>m</u> <u>hōa</u> <u>hwa</u> <u>tāg</u> <u>hōka</u>
<u>D2</u> <u>m</u> <u>hōa</u> <u>hwa</u> <u>tāg</u> <u>hōka</u>	<u>C6</u> <u>hōa</u> <u>hwa</u> <u>tāg</u> <u>hōka</u>	<u>B4</u> <u>m</u> <u>hōa</u> <u>hwa</u> <u>tāg</u> <u>hōka</u>	<u>B3</u> <u>m</u> <u>hōa</u> <u>hwa</u> <u>tāg</u> <u>hōka</u>	<u>D5</u> <u>m</u> <u>hōa</u> <u>hwa</u> <u>tāg</u> <u>hōka</u>
<u>D1</u> <u>m</u> <u>hōa</u> <u>hwa</u> <u>tāg</u> <u>hōka</u>	<u>C6</u> <u>hōa</u> <u>hwa</u> <u>tāg</u> <u>hōka</u>	<u>B4</u> <u>m</u> <u>hōa</u> <u>hwa</u> <u>tāg</u> <u>hōka</u>	<u>B3</u> <u>m</u> <u>hōa</u> <u>hwa</u> <u>tāg</u> <u>hōka</u>	<u>D5</u> <u>m</u> <u>hōa</u> <u>hwa</u> <u>tāg</u> <u>hōka</u>

1/2
 1/2
 1/2

1/2
 1/2
 1/2

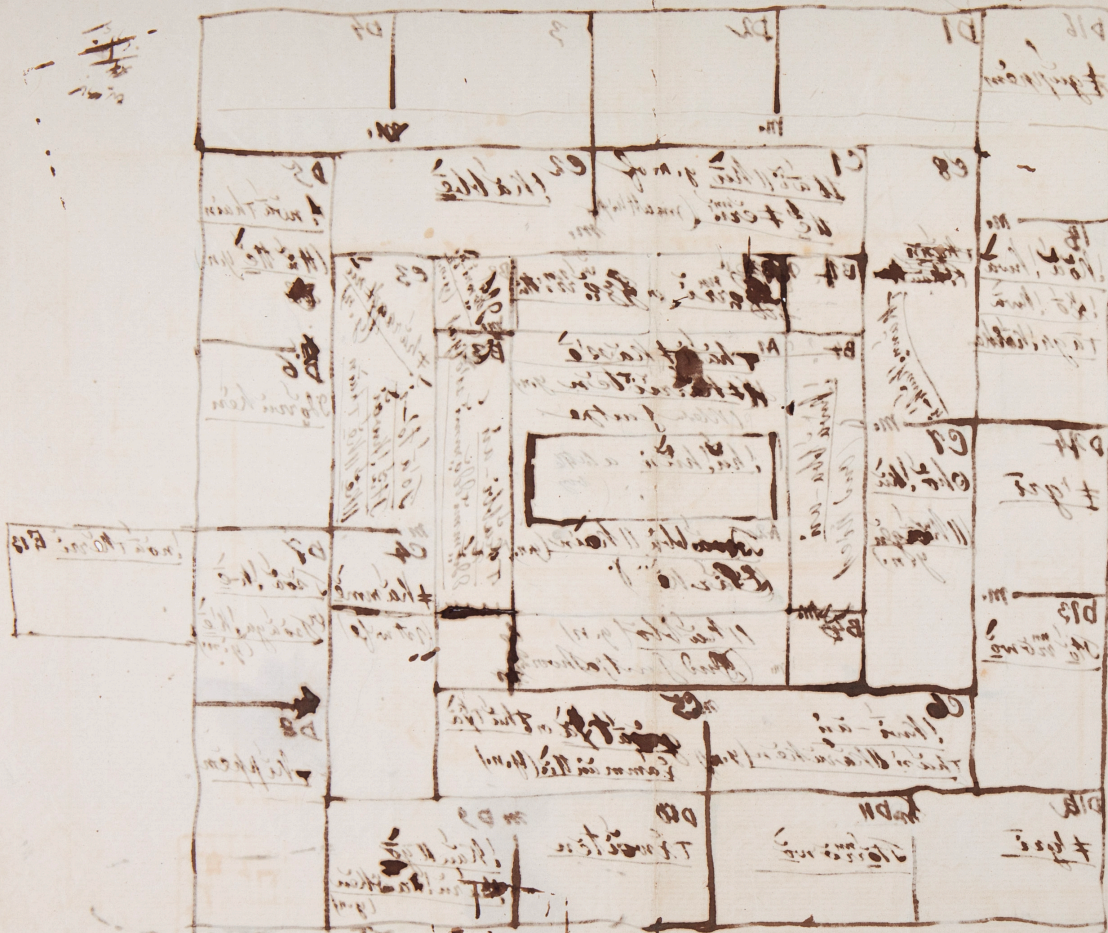

2-1-A
 4-2-B
 8-3-C
 16-4-D
 32-5-E
 64-6-F
 128-7-G
 256-8-H
 512-9-I
 1024-10-J
 2048-11-K
 4096-12-L
 8192-13-M
 16384-14-N
 32768-15-O
 65536-16-P
 131072-17-Q
 262144-18-R
 524288-19-S
 1,048,576-20-T
 2,097,152-21-V
 4,194,304-22-V
 8,388,608-23-W
 16,777,216-24-X
 33,554,432-25-Y
 67,108,864-26-Z
 134,217,728-27-AA
 268,435,456-28-BB
 536,870,912-29-CC
 1,073,741,824-30-DD
 2,147,483,648-31-EE
 4,294,967,296-32-FF

5/2/82
10/2/82

BC151 E12.4.11

5/2/82
10/2/82

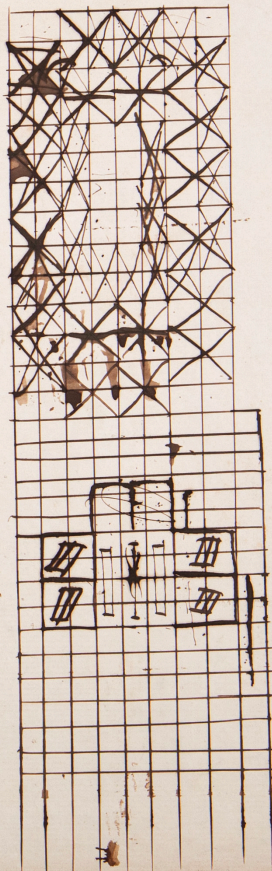

4/4/1
10/2/82

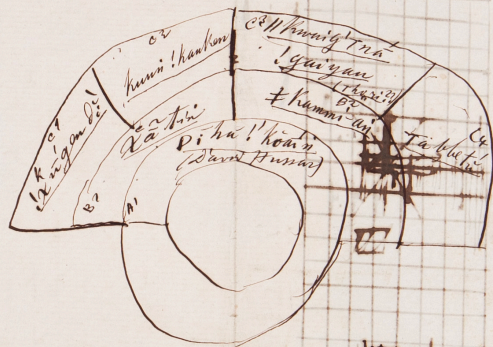

Handwritten notes in the top right corner, including the number 15 and some illegible text.

Bushman Genealogy

Diagram I.

BC 151 E12 412

ANCESTORS OF !hu!huin, son of !hain + !haisi (Ph. XIII. 101-102) and grandson of !haisi (Ph. I. 1-4)

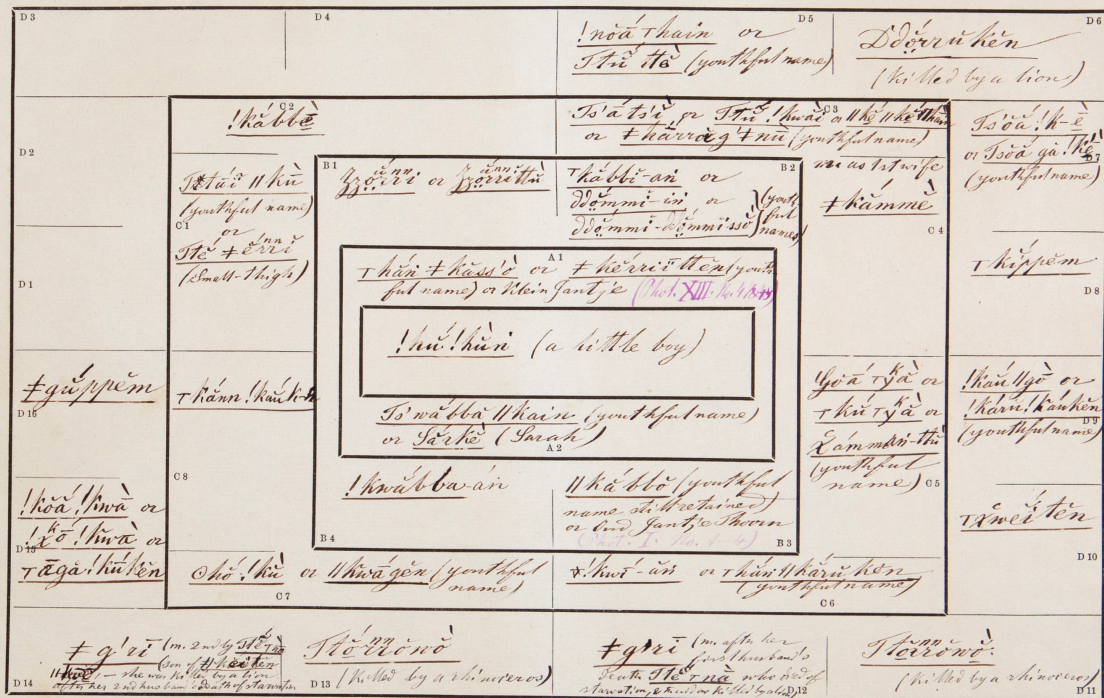

Odd numbers indicate males (fathers, grandfathers, &c.)
Even " " females (mothers, grandmothers, &c.)

A = Father (A 1) and Mother (A 2)

B = { Grandfathers (B 1 father's father)
and (B 3 mother's father)
Grandmothers (B 2 father's mother)
(B 4 mother's mother)

C = { Great-grandfathers (C 1 father's father's father)
and (C 3 father's mother's father)
Great-grandmothers (C 2 father's father's mother)
(C 4 father's mother's mother)
(C 6 mother's father's mother)
(C 8 mother's mother's mother)

D = { Great-great-grandfathers (D 1 father's father's father's father)
and (D 3 father's father's mother's father)
Great-great-grandmothers (D 2 father's father's father's mother)
(D 4 father's father's mother's mother)
(D 6 father's mother's father's father)
(D 8 father's mother's mother's father)
(D 10 mother's father's father's father)
(D 12 mother's father's mother's father)
(D 14 mother's mother's father's father)
(D 16 mother's mother's mother's father)

D = { Great-great-grandfathers (D 1 father's father's father's father)
and (D 3 father's father's mother's father)
Great-great-grandmothers (D 2 father's father's father's mother)
(D 4 father's father's mother's mother)
(D 6 father's mother's father's father)
(D 8 father's mother's mother's father)
(D 10 mother's father's father's father)
(D 12 mother's father's mother's father)
(D 14 mother's mother's father's father)
(D 16 mother's mother's mother's father)

Bushman Genealogy Diagram II.

80151 E12.613

ANCESTORS OF the children of !gübbü (Neos Tontje) Phot. II. No. 5-10.

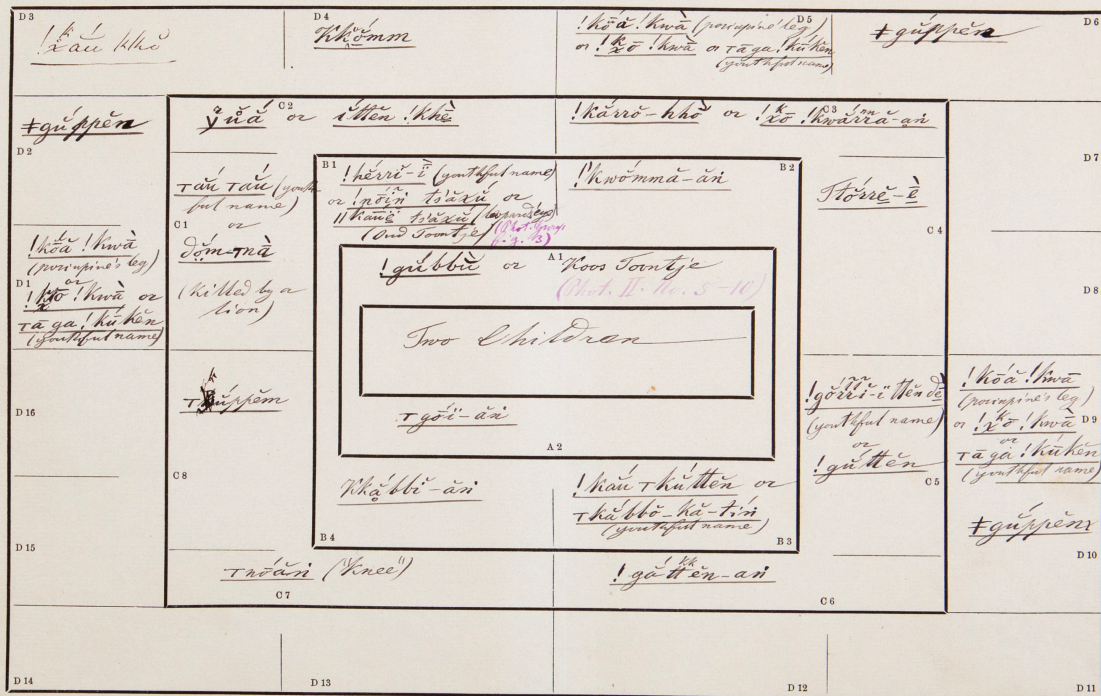

Odd numbers indicate males (fathers, grandfathers, etc.)
Even " " females (mothers, grandmothers, etc.)

A = Father (A 1) and Mother (A 2)

B = { Grandfathers (B 1 father's father)
and (B 2 mother's father)
Grandmothers (B 3 father's mother)
(B 4 mother's mother)

C = { Great-grandfathers (C 1 father's father's father)
and (C 2 father's mother's father)
(C 3 father's father's father)
(C 4 father's mother's father)
Great-grandmothers (C 5 father's father's mother)
(C 6 father's mother's mother)
(C 7 mother's father's father)
(C 8 mother's mother's mother)

D = { Great-great-grandfathers (D 1 father's father's father's father)
and (D 2 father's father's mother's father)
(D 3 father's father's father's mother)
(D 4 father's mother's father's father)
(D 5 father's mother's father's mother)
(D 6 father's father's mother's father)
(D 7 father's mother's mother's father)
(D 8 mother's father's father's father)
(D 9 mother's father's father's mother)
(D 10 mother's mother's father's father)
(D 11 mother's mother's mother's father)
(D 12 mother's father's mother's father)
(D 13 mother's mother's father's mother)
(D 14 mother's mother's mother's father)
(D 15 mother's mother's mother's mother)
(D 16 mother's mother's mother's mother)

Bushman Genealogy Diagram III.

BC 151 E12-4-14

ANCESTORS OF the daughter of *Uka'ba'chi'gi'gi* (Phot. III. No. 11-14).

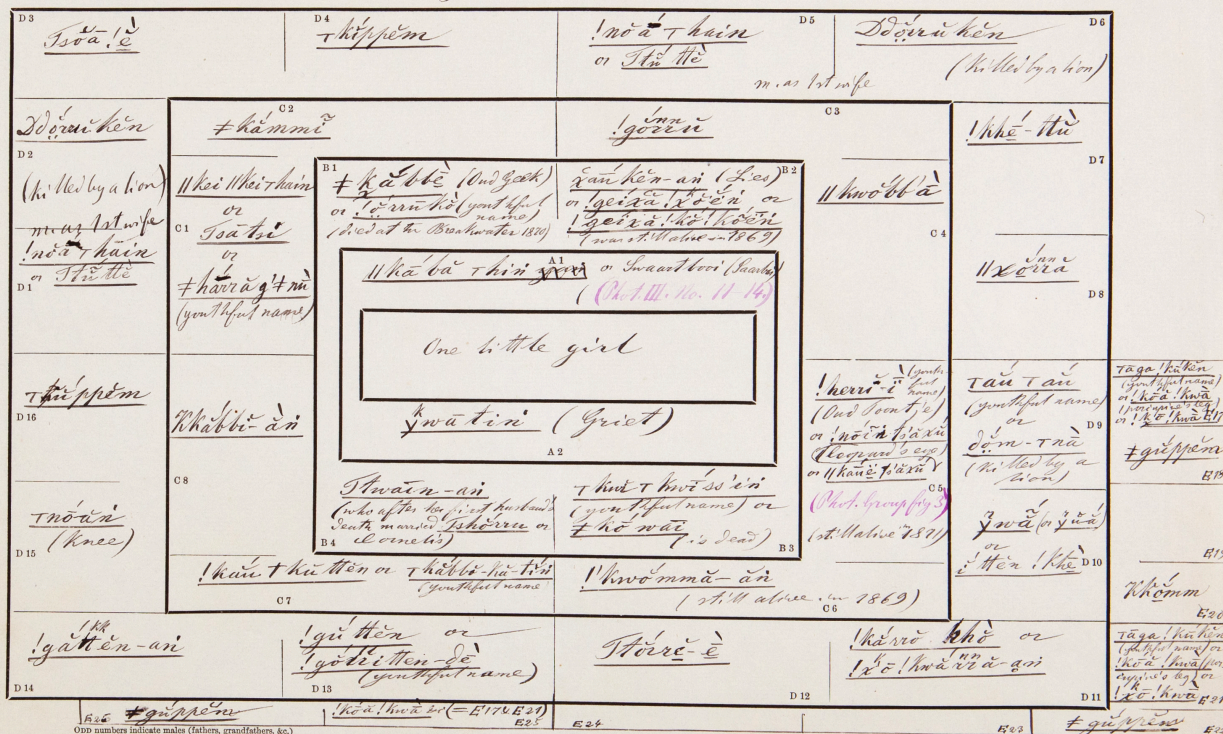

Odd numbers indicate males (fathers, grandfathers, &c.)

Even " " females (mothers, grandmothers, &c.)

A = Father (A 1) and Mother (A 2)

B = { Grandfathers (B 1 father's father)
and (B 3 mother's father)
Grandmothers (B 2 father's mother)
(B 4 mother's mother)

C = { Great-grandfathers (C 1 father's father's father)
(C 3 father's mother's father)
(C 5 father's father's mother)
(C 7 mother's mother's father)
Great-grandmothers (C 2 father's father's mother)
(C 4 father's mother's mother)
(C 6 mother's father's mother)
(C 8 mother's mother's mother)

D = { Great-great-grandfathers (D 1 father's father's father's father)
(D 3 father's father's mother's father)
(D 5 father's mother's father's father)
(D 7 father's mother's mother's father)
(D 9 mother's father's father's father)
(D 11 mother's father's mother's father)
(D 13 mother's mother's father's father)
(D 15 mother's mother's mother's father)
and Great-great-grandmothers (D 2 father's father's father's mother)
(D 4 father's father's mother's mother)
(D 6 father's mother's father's mother)
(D 8 father's mother's mother's mother)
(D 10 mother's father's mother's mother)
(D 12 mother's mother's father's mother)
(D 14 mother's mother's mother's mother)

NB. The ancestors of *!khe'tu* (Phot. Group fig. 4) are the same as those of *!khe'tu* (A1)

BC151 E1.2.4.15

[illegible]

ODD numbers indicate males (fathers, grandfathers, &c.)
EVEN " " females (mothers, grandmothers, &c.)

A = Father (A 1) and Mother (A 2)

C. Grandfathers (B1, father's father)

Grandmothers	(B1 father's father)
and	(B3 mother's father)

B = } And
Grandmothers (B 2 father's mother)

Grandmothers (B 2 father's mother;
(B 4 mother's mother)

C_{sex} { Great-grandfathers (C1 father's father's father)
and (C3 father's mother's father)
(C5 father's father's father)
(C7 mother's mother's father)
Great-grandmothers. (C2 father's father's mother)
(C4 father's mother's mother)
(C6 mother's father's mother)
(C8 mother's mother's mother)

	Great-grand-fathers	and	Great-grand-mothers
	(D 1 father's father's father)		(D 2 father's father's father's mother)
	(D 3 father's father's mother's father)		(D 4 father's father's mother's mother)
	(D 5 father's mother's father's father)		(D 6 father's mother's father's mother)
D =	(D 7 father's mother's mother's father)		(D 8 father's mother's mother's mother)
	(D 9 mother's father's father's father)		(D 10 mother's father's father's mother)
	(D 11 mother's father's mother's father)		(D 12 mother's father's mother's mother)
	(D 13 mother's mother's father's father)		(D 14 mother's mother's father's mother)
	(D 15 mother's mother's mother's father)		(D 16 mother's mother's mother's mother)

N.B. The ancestors of ra'k'inilā' (Phot. XI. No. 43x44) are the same as those of amirshō' (A1).

Bushman Genealogy Diagram VI. B.C. 151 B.D. 214

ANCESTORS OF the children of Hain or Jacob Hijn (Phot. XII. No. 8344)

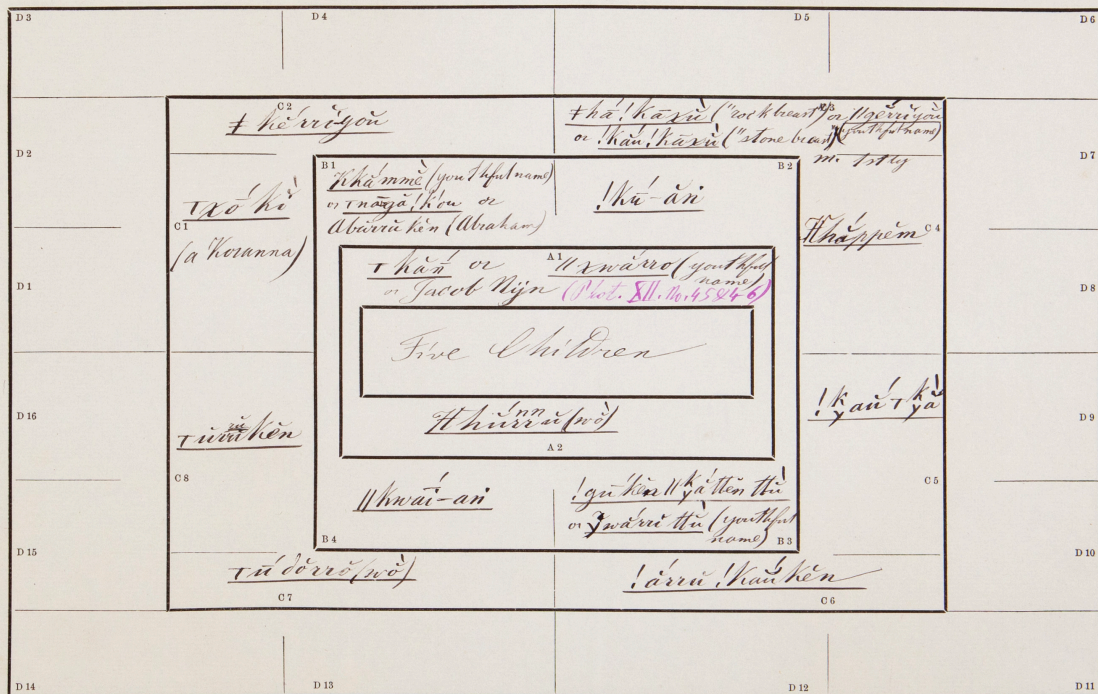

A = Father (A 1) and Mother (A 2)

$$B = \begin{cases} \text{Grandfathers} & (B1 \text{ father's father}) \\ & (B3 \text{ mother's father}) \\ \text{and} \\ \text{Grandmothers} & (B2 \text{ father's mother}) \\ & (B4 \text{ mother's mother}) \end{cases}$$

$C = \left\{ \begin{array}{ll} \text{Great-grandfathers} & (C1 \text{ father's father's father}) \\ & (C3 \text{ father's mother's father}) \\ & (C5 \text{ father's father's father}) \\ \text{and} & (C7 \text{ mother's mother's father}) \\ \text{Great-grandmothers.} & (C2 \text{ father's father's mother}) \\ & (C4 \text{ father's mother's mother}) \\ & (C6 \text{ mother's father's mother}) \\ & (C8 \text{ mother's mother's mother}) \end{array} \right.$

	Great-grand-fathers	Great-grand-mothers
D=	(D1 father's father's father's father)	(D2 father's father's father's mother)
	(D3 father's father's mother's father)	(D4 father's father's mother's mother)
	(D5 father's mother's father's father)	(D6 father's mother's father's mother)
	(D7 father's mother's mother's father)	(D8 father's mother's mother's mother)
	(D9 mother's father's father's father)	(D10 mother's father's father's mother)
	(D11 mother's father's mother's father)	(D12 mother's father's mother's mother)
	(D13 mother's mother's father's father)	(D14 mother's mother's father's mother)
	(D15 mother's mother's mother's father)	(D16 mother's mother's mother's mother)

Bushman Genealogy Diagram VII.

BC 151 E 12.4.18

ANCESTORS OF Wō'Wō'kēn, the daughter of W'haūvū (Phot. Group fig. 2.)

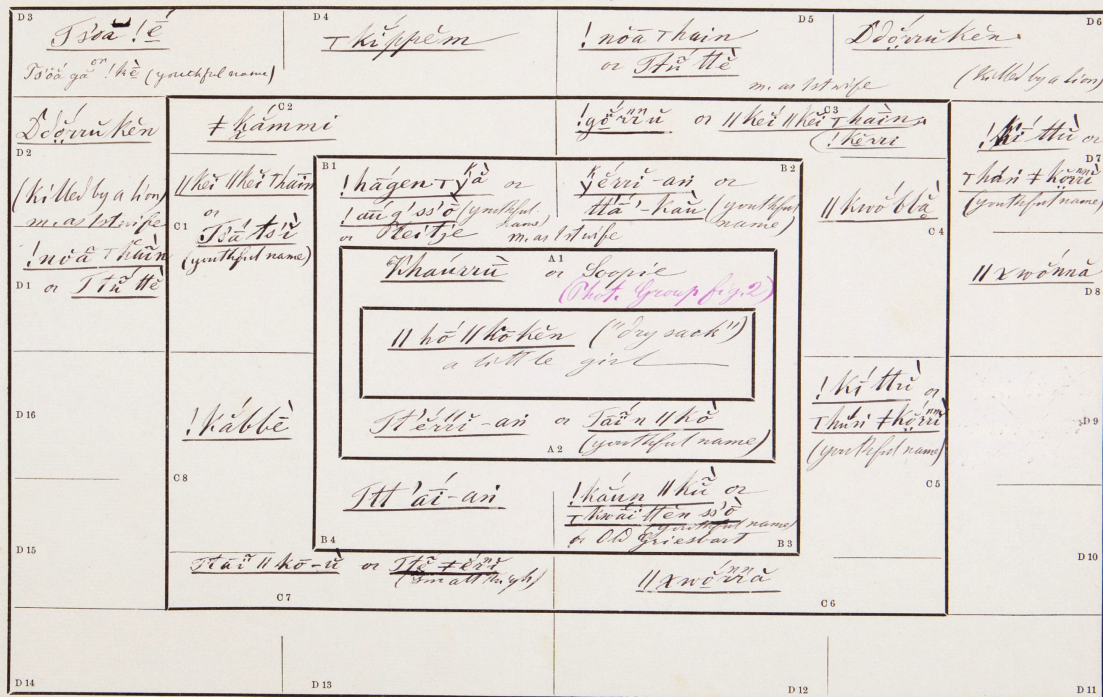

Odd numbers indicate males (fathers, grandfathers, &c.)
Even " " females (mothers, grandmothers, &c.)

A = Father (A 1) and Mother (A 2)

B = Grandfathers (B 1 father's father)
and
Grandmothers (B 2 father's mother)
(B 3 mother's father)
(B 4 mother's mother)

C = Great-grandfathers

(C 1 father's father's father)
(C 2 father's mother's father)
(C 3 father's father's mother)
(C 4 father's mother's mother)
(C 5 mother's father's father)
(C 6 mother's mother's father)
(C 7 mother's father's mother)
(C 8 mother's mother's mother)

D = Great-great-grandfathers

and Great-great-grandmothers
(D 1 father's father's father's father)
(D 2 father's father's father's mother)
(D 3 father's father's mother's father)
(D 4 father's father's mother's mother)
(D 5 father's mother's father's father)
(D 6 father's mother's father's mother)
(D 7 father's mother's mother's father)
(D 8 father's mother's mother's mother)
(D 9 mother's father's father's father)
(D 10 mother's father's father's mother)
(D 11 mother's father's mother's father)
(D 12 mother's father's mother's mother)
(D 13 mother's mother's father's father)
(D 14 mother's mother's father's mother)
(D 15 mother's mother's mother's father)
(D 16 mother's mother's mother's mother)

Bushman Genealogy Diagram VIII.

BC 151 E. 2. 10. 19

ANCESTORS OF *Thwāgen twāgen-i*, daughter of *Thwāren* or *Conchie* (Shot. Geography. 5.)

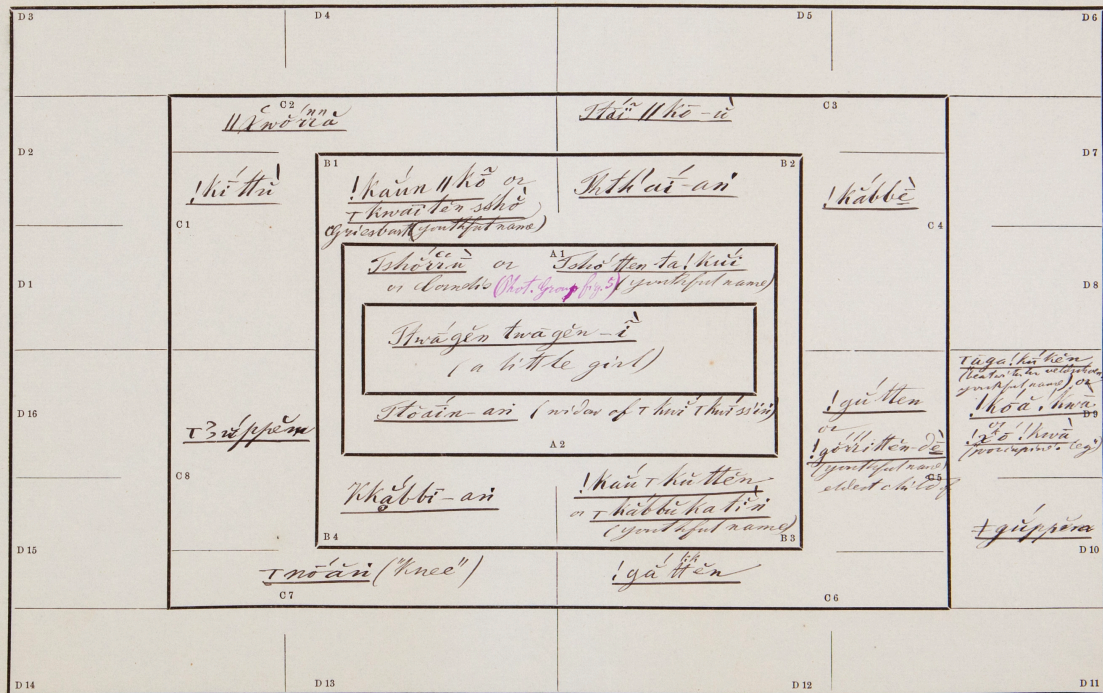

Odd numbers indicate males (fathers, grandfathers, &c.)
Even " " females (mothers, grandmothers, &c.)

A = Father (A 1) and Mother (A 2)

B = { Grandfathers (B 1 father's father)
and (B 3 mother's father)
Grandmothers (B 2 father's mother)
(B 4 mother's mother)

C = { Great-grandfathers (C 1 father's father's father)
and (C 3 father's mother's father)
(C 5 father's father's father)
(C 7 mother's mother's father)
Great-grandmothers (C 2 father's father's mother)
(C 4 father's mother's mother)
(C 6 mother's father's mother)
(C 8 mother's mother's mother)

D = { Great-great-grandfathers and Great-great-grandmothers
(D 1 father's father's father's father) (D 2 father's father's father's mother)
(D 3 father's father's mother's father) (D 4 father's father's mother's mother)
(D 5 father's mother's father's father) (D 6 father's mother's father's mother)
(D 7 father's mother's mother's father) (D 8 father's mother's mother's mother)
(D 9 mother's father's father's father) (D 10 mother's father's father's mother)
(D 11 mother's father's mother's father) (D 12 mother's father's mother's mother)
(D 13 mother's mother's father's father) (D 14 mother's mother's father's mother)
(D 15 mother's mother's mother's father) (D 16 mother's mother's mother's mother)

Bushman Genealogy

Diagram IX.

ANCESTORS OF Kūshi or Coos Pleitje (Phot. Group fig. 5)

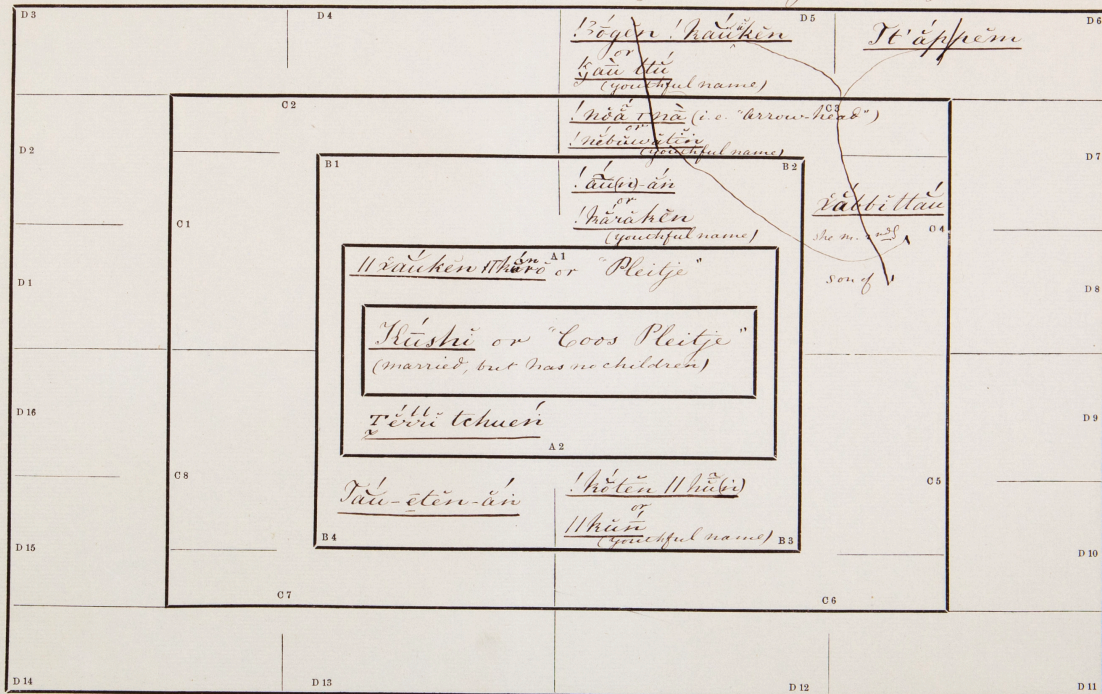

Odd numbers indicate males (fathers, grandfathers, &c.)
Even " " females (mothers, grandmothers, &c.)

A = Father (A 1) and Mother (A 2)

B = { Grandfathers (B 1 father's father)
and (B 3 mother's father)
Grandmothers (B 2 father's mother)
(B 4 mother's mother)

C = { Great-grandfathers (C 1 father's father's father)
(C 3 father's mother's father)
(C 5 father's mother's father's father)
and (C 7 mother's mother's father's father)
Great-grandmothers (C 2 father's father's mother)
(C 4 father's mother's mother)
(C 6 mother's father's mother)
(C 8 mother's mother's mother)

D = { Great-great-grandfathers (D 1 father's father's father's father)
(D 3 father's father's mother's father's father)
(D 5 father's mother's father's father's father)
and (D 7 father's mother's mother's father's father)
(D 9 mother's father's father's father's father)
(D 11 mother's father's mother's father's father)
(D 13 mother's mother's father's father's father)
Great-great-grandmothers (D 2 father's father's father's mother)
(D 4 father's father's mother's mother's father)
(D 6 father's mother's father's mother's father)
(D 8 father's mother's mother's mother's father)
(D 10 mother's father's mother's mother's father)
(D 12 mother's father's mother's mother's mother's father)
(D 14 mother's mother's father's mother's mother's father)
(D 16 mother's mother's mother's mother's mother's father)

Bushman Genealogy Diagram IX.

BC 151 E. 2. 4. 21

ANCESTORS OF Kushi or Cocs Pleitje (Phot. Group. fig. 6)

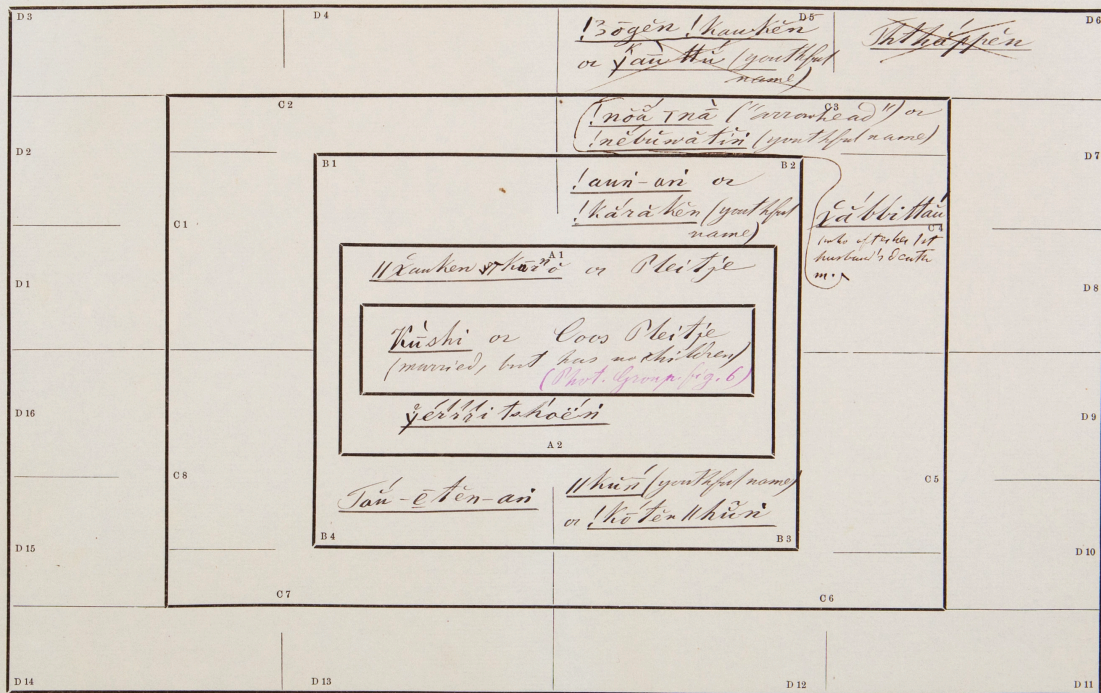

ODD numbers indicate males (fathers, grandfathers, &c.)
EVEN " " females (mothers, grandmothers, &c.)

A = Father (A 1) and Mother (A 2)

B = { Grandfathers (B 1 father's father)
and (B 3 mother's father)
Grandmothers (B 2 father's mother)
(B 4 mother's mother)

C = { Great-grandfathers (C 1 father's father's father)
(C 3 father's mother's father)
(C 5 father's father's father)
(C 7 mother's mother's father)
and
Great-grandmothers (C 2 father's father's mother)
(C 4 father's mother's mother)
(C 6 mother's father's mother)
(C 8 mother's mother's mother)

D = { Great-great-grandfathers (D 1 father's father's father's father)
(D 3 father's father's mother's father)
(D 5 father's mother's father's father)
(D 7 father's mother's mother's father)
(D 9 mother's father's father's father)
(D 11 mother's father's mother's father)
(D 13 mother's mother's father's father)
(D 15 mother's mother's mother's father)
and Great-great-grandmothers (D 2 father's father's father's mother)
(D 4 father's father's mother's mother)
(D 6 father's mother's father's mother)
(D 8 father's mother's mother's mother)
(D 10 mother's father's father's mother)
(D 12 mother's father's mother's mother)
(D 14 mother's mother's father's mother)
(D 16 mother's mother's mother's mother)

Bushman Genealogy Diagram X.

ANCESTORS OF the children of !vāri-ttēn or Jacob (Not Group fig. 1)

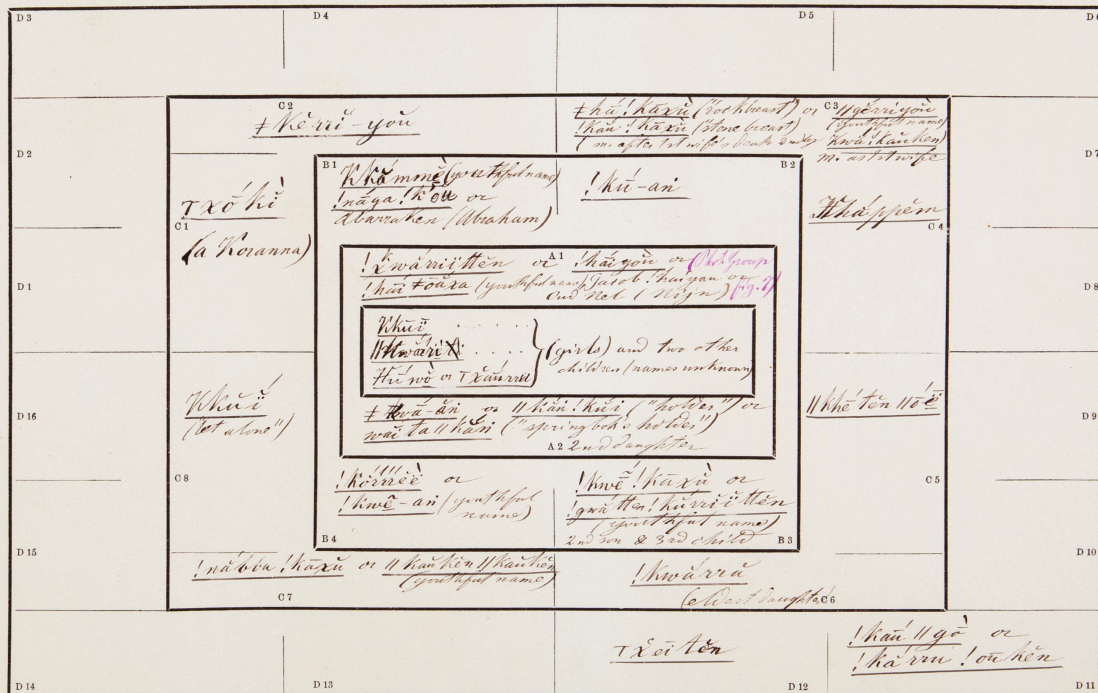

Odd numbers indicate males (fathers, grandfathers, &c.)
Even " " females (mothers, grandmothers, &c.)

A = Father (A 1) and Mother (A 2)

B = { Grandfathers (B 1 father's father)
and (B 2 mother's father)
Grandmothers (B 2 mother's mother)

C = { Great-grandfathers (C 1 father's father's father)
and (C 2 father's mother's father)
(C 3 father's father's father)
Great-grandmothers (C 2 father's father's mother)
(C 4 father's mother's mother)
(C 5 mother's father's mother)
(C 6 mother's mother's mother)

D = { Great-grand-fathers and Great-grand-mothers
(D 1 father's father's father's father)
(D 2 father's father's father's mother)
(D 3 father's father's mother's father)
(D 4 father's father's mother's mother)
(D 5 father's mother's father's father)
(D 6 father's mother's father's mother)
(D 7 father's mother's mother's father)
(D 8 father's mother's mother's mother)
(D 9 mother's father's father's father)
(D 10 mother's father's father's mother)
(D 11 mother's father's mother's father)
(D 12 mother's father's mother's mother)
(D 13 mother's mother's father's father)
(D 14 mother's mother's father's mother)
(D 15 mother's mother's mother's father)
(D 16 mother's mother's mother's mother)

Bushman Genealogy Diagram XI.

BC151 E1.2.4.23

ANCESTORS OF the children of Gantarru or Klaas (Phot. Group fig. 8)

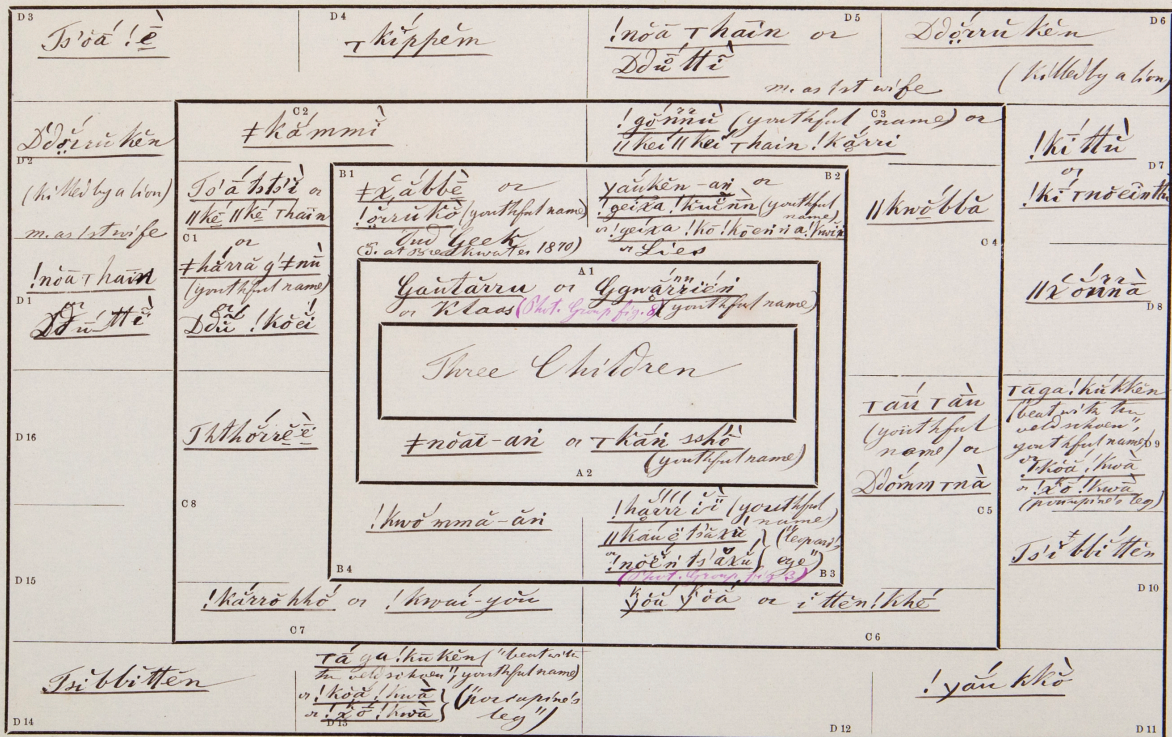

Odd numbers indicate males (fathers, grandfathers, &c.)
Even " " females (mothers, grandmothers, &c.)

A = Father (A1) and Mother (A2)

B = { Grandfathers (B1 father's father)
and (B3 mother's father)
Grandmothers (B2 father's mother)
(B4 mother's mother)

C = { Great-grandfathers (C1 father's father's father)
and (C3 father's mother's father)
(C5 father's father's father)
Great-grandmothers (C2 father's father's mother)
(C4 father's mother's mother)
(C6 mother's father's mother)
(C8 mother's mother's mother)

D = { Great-great-grandfathers (D1 father's father's father's father)
(D3 father's father's mother's father)
(D5 father's mother's father's father)
(D7 father's mother's mother's father)
(D9 mother's father's father's father)
(D11 mother's father's mother's father)
(D13 mother's mother's father's father)
(D15 mother's mother's mother's father)
and Great-great-grandmothers (D2 father's father's mother's mother)
(D4 father's father's mother's mother)
(D6 father's mother's father's mother)
(D8 father's mother's mother's mother)
(D10 mother's father's mother's mother)
(D12 mother's father's mother's mother)
(D14 mother's mother's mother's mother)
(D16 mother's mother's mother's mother)

Bushman Genealogy Diagram XII.

ANCESTORS OF *the children of 1130¹ or "Adam Fix" (Phot. Group fig. 10.)*

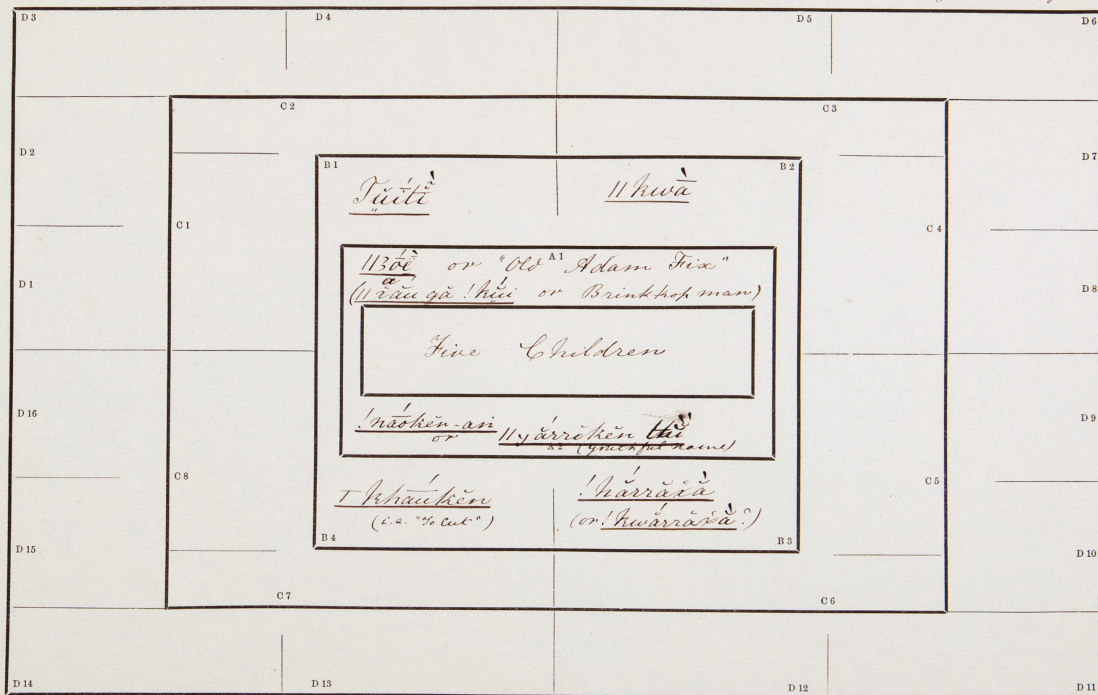

Odd numbers indicate males (fathers, grandfathers, &c.)
Even " " females (mothers, grandmothers, &c.)

A = Father (A 1) and Mother (A 2)

B = { Grandfathers (B 1 father's father)
and (B 3 mother's father)
Grandmothers (B 2 father's mother)
(B 4 mother's mother)

C = { Great-grandfathers (C 1 father's father's father)
and (C 3 father's mother's father)
(C 5 father's father's father)
(C 7 mother's mother's father)
Great-grandmothers (C 2 father's father's mother)
(C 4 father's mother's mother)
(C 6 mother's father's mother)
(C 8 mother's mother's mother)

D = { Great-great-grandfathers (D 1 father's father's father's father)
and Great-great-grandmothers (D 2 father's father's father's mother)
(D 3 father's father's mother's father)
(D 4 father's father's mother's mother)
(D 5 father's mother's father's father)
(D 6 father's mother's father's mother)
(D 7 father's mother's mother's father)
(D 8 father's mother's mother's mother)
(D 9 mother's father's father's father)
(D 10 mother's father's father's mother)
(D 11 mother's father's mother's father)
(D 12 mother's father's mother's mother)
(D 13 mother's mother's father's father)
(D 14 mother's mother's father's mother)
(D 15 mother's mother's mother's father)
(D 16 mother's mother's mother's mother)

Bushman Genealogy Diagram XII.

ANCESTORS OF the children of 1136E or Wam Pix (Nt. Group fig. 4)

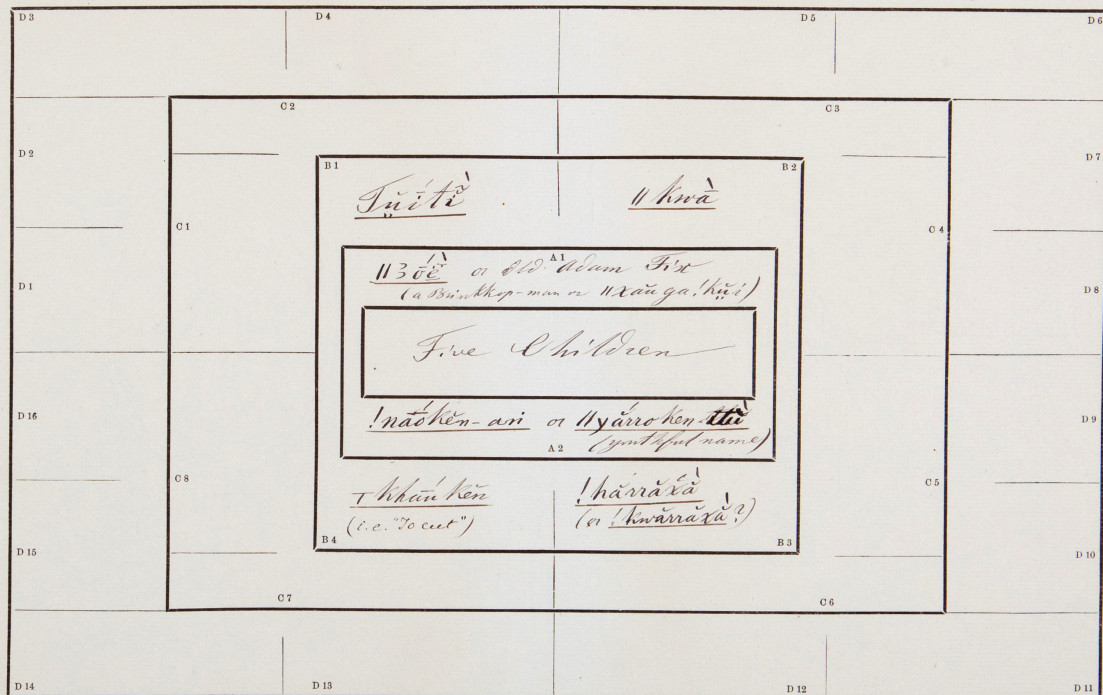

Odd numbers indicate males (fathers, grandfathers, &c.)
Even " " females (mothers, grandmothers, &c.)

A = Father (A 1) and Mother (A 2)

B = { Grandfathers (B 1 father's father)
and (B 2 mother's father)
Grandmothers (B 3 father's mother)
(B 4 mother's mother)

C = { Great-grandfathers (C 1 father's father's father)
(C 2 father's mother's father)
(C 3 father's father's mother)
(C 4 mother's father's father)
and (C 5 mother's father's mother)
Great-grandmothers (C 6 father's mother's mother)
(C 7 father's mother's mother)
(C 8 mother's mother's mother)

D = { Great-great-grandfathers and Great-great-grandmothers
(D 1 father's father's father's father)
(D 2 father's father's father's mother)
(D 3 father's father's mother's father)
(D 4 father's father's mother's mother)
(D 5 father's mother's father's father)
(D 6 father's mother's father's mother)
(D 7 father's mother's mother's father)
(D 8 father's mother's mother's mother)
(D 9 mother's father's father's father)
(D 10 mother's father's father's mother)
(D 11 mother's father's mother's father)
(D 12 mother's father's mother's mother)
(D 13 mother's mother's father's father)
(D 14 mother's mother's father's mother)
(D 15 mother's mother's mother's father)
(D 16 mother's mother's mother's mother)

the child of

ANCESTORS OF Tā!kūn tā' or Stoffel (Christ) and his wife Ka or Marie

D3	<u>Tōa!ē</u>	D4	<u>Tāppem</u>	D5	<u>!kē tū</u>	D6	<u>!pwaē!ā</u>
D2	<u>!Dhārukē</u>	C2 <u>!vāmni</u>		C3 <u>!kambillgo (gr. exbat)</u>		D7 <u>!Hāi Whēē</u>	
		C1 <u>#kai #kai tū</u> or <u>!Tōa!ē (y.m)</u>	B1 <u>!hā kē tū</u> or <u>!ān-sōē (y.m)</u>		B2 <u>!Hā kē -āi</u>		
D1	<u>!noā thān</u>	<div style="border: 1px solid black; padding: 10px; text-align: center;"> <u>Tā!kūn tā' (Stoffel)</u> <div style="border: 1px solid black; height: 50px; width: 100%; margin: 10px 0;"></div> <u>Kā or Marie</u> 3rd child of A2 & 4th child of </div>				C4 <u>!Hāi -āi</u>	D8 <u>!kabbē</u>
D16	<u>!hāmm-āi</u>	C8 <u>!gāō kēn</u> or <u>!gāō!kē</u> (y.m)				D9 <u>!kūn ho</u>	
	<u>!hāgēn!hācēn</u> or <u>!hāgēn!hācēn!hā</u> (y.m)	C8 <u>!hāgēn!hācēn</u> (y.m)	B4 <u>!hāgēn!hācēn</u> (y.m)		C5 <u>!kōē-yan (y.m) or</u> <u>!kōē!nōā or</u> <u>!hāgēn!hācēn</u> (y.m)		D10 <u>!kēn</u>
D15		C7 <u>!hāgēn!hācēn</u> (y.m)			B3 <u>!hāgēn!hācēn</u> (y.m)		
		C7 <u>!hāgēn!hācēn</u> (y.m)			C6 <u>!hāgēn!hācēn</u> (y.m)		
D14	<u>!hāgēn!hācēn</u>	D13			D12 <u>!hāgēn!hācēn</u> (y.m)		D11 <u>!hāgēn!hācēn</u> (y.m)

Odd numbers indicate males (fathers, grandfathers, etc.)
Even " " females (mothers, grandmothers, etc.)

A = Father (A 1) and Mother (A 2)

B = { Grandfathers (B 1 father's father)
and (B 2 mother's father)
Grandmothers (B 2 father's mother)
(B 4 mother's mother)

C = { Great-grandfathers (C 1 father's father's father)
(C 3 father's mother's father)
(C 5 father's father's father)
(C 7 mother's mother's father)
Great-grandmothers (C 2 father's father's mother)
(C 4 father's mother's mother)
(C 6 mother's father's mother)
(C 8 mother's mother's mother)

D = { Great-great-grandfathers and Great-great-grandmothers
(D 1 father's father's father's father)
(D 2 father's father's father's mother)
(D 3 father's father's mother's father)
(D 4 father's father's mother's mother)
(D 5 father's mother's father's father)
(D 6 father's mother's father's mother)
(D 7 father's mother's mother's father)
(D 8 father's mother's mother's mother)
(D 9 mother's father's father's father)
(D 10 mother's father's father's mother)
(D 11 mother's father's mother's father)
(D 12 mother's father's mother's mother)
(D 13 mother's mother's father's father)
(D 14 mother's mother's father's mother)
(D 15 mother's mother's mother's father)
(D 16 mother's mother's mother's mother)

ANCESTORS OF

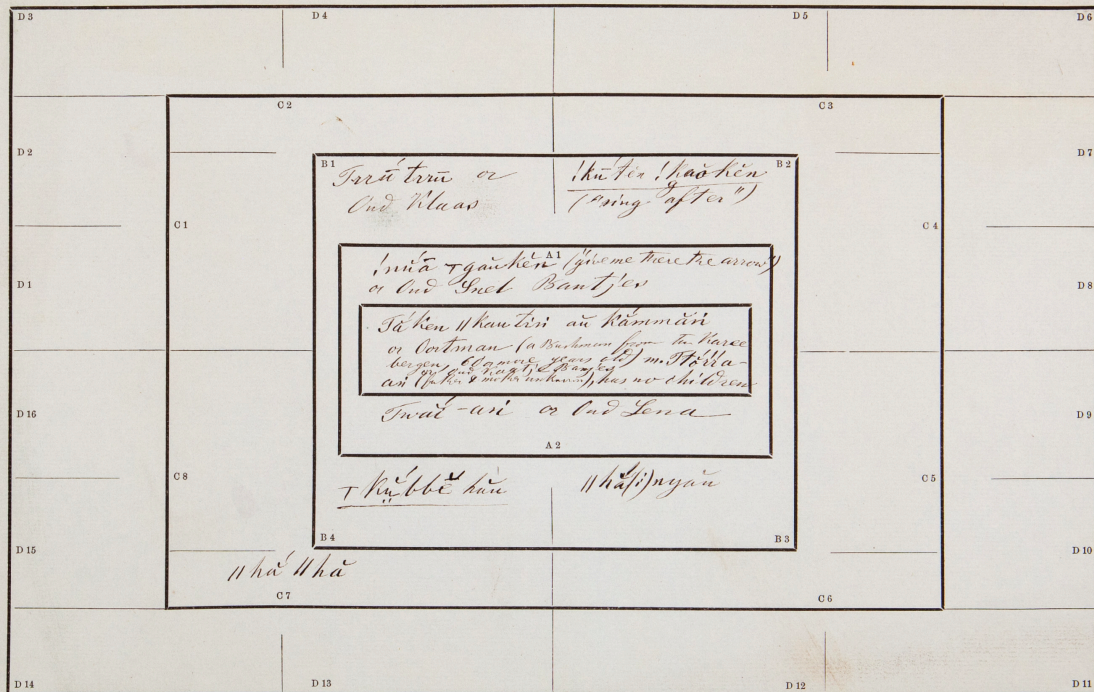

ODD numbers indicate males (fathers, grandfathers, &c.)
EVEN " " females (mothers, grandmothers, &c.)

A = Father (A 1) and Mother (A 2)

$$B = \begin{cases} \text{Grandfathers} & (B1 \text{ father's father}) \\ & \text{and} & (B3 \text{ mother's father}) \\ \text{Grandmothers} & (B2 \text{ father's mother}) \\ & & (B4 \text{ mother's mother}) \end{cases}$$

C = {
 Great-grandfathers (C1 father's father's father)
 (C3 father's mother's father)
 (C5 father's father's father)
 (C7 mother's mother's father)
 and
 Great-grandmothers. (C2 father's father's mother)
 (C4 father's mother's mother)
 (C6 mother's father's mother)
 (C8 mother's mother's mother)

	Great-grand-fathers	Great-grand-mothers
=	(D 1 father's father's father's father)	(D 2 father's father's father's mother)
	(D 3 father's father's mother's father)	(D 4 father's father's mother's mother)
	(D 5 father's mother's father's father)	(D 6 father's mother's father's mother)
	(D 7 father's mother's mother's father)	(D 8 father's mother's mother's mother)
	(D 9 mother's father's father's father)	(D 10 mother's father's father's mother)
	(D 11 mother's father's mother's father)	(D 12 mother's father's mother's mother)
=	(D 13 mother's mother's father's father)	(D 14 mother's mother's father's mother)
	(D 15 mother's mother's mother's father)	(D 16 mother's mother's mother's mother)

ANCESTORS OF *the children of Si'a 'Kwain*

T'Kho'-an B2
~~*# kumme-an*~~
Söro (Anndke)

D3	D4	D5	D6	
D2	<p>Twa'bbu-ken, kum-ken (T'vri) died of illness at an old age</p>	<p>U'khar-di-g' T'vri died of an illness a long time ago</p>	D7	
D1	<p>!x'ng'en di' (Klaus) died long ago of sickness</p>	<p>!x'at'in (Jakob Floezar) died about 12 years ago of illness</p> <div style="border: 1px solid black; padding: 5px; margin: 5px;"> <p>Si'a 'Kwain (or David Floezar)</p> <p>Three children (B'vri's, T'vri's, Yriet ♀) in service with Buers</p> <p>Miethe, died about 12 years ago of illness</p> <p>!ku'-k'vri (T'vri) died of dropsy</p> </div>	<p>* k'vri-!k'vri (Anns'ke) died about a few years ago</p> <p>!k'vri-!k'vri died also of an illness when her grandson was a very small child</p>	D8
D16	<p>Twa'bbu-ken !kum-ken (T'vri)</p>		D9	
D15	!x'ng'en di' (Klaus)		D10	
D14	D13	D12	D11	

Odd numbers indicate males (fathers, grandfathers, &c.)
Even " " females (mothers, grandmothers, &c.)

A = Father (A 1) and Mother (A 2)

B = { Grandfathers (B 1 father's father)
and (B 2 mother's father)
Grandmothers (B 2 father's mother)
(B 4 mother's mother)

C = { Great-grandfathers (C 1 father's father's father)
and (C 2 father's mother's father)
(C 3 father's father's father)
(C 7 mother's mother's father)
Great-grandmothers (C 2 father's father's mother)
(C 4 father's mother's mother)
(C 6 mother's father's mother)
(C 8 mother's mother's mother)

D = { Great-great-grandfathers and Great-great-grandmothers
(D 1 father's father's father's father) (D 2 father's father's father's mother)
(D 3 father's father's mother's father) (D 4 father's father's mother's mother)
(D 5 father's mother's father's father) (D 6 father's mother's father's mother)
(D 7 father's mother's mother's father) (D 8 father's mother's mother's mother)
(D 9 mother's father's father's father) (D 10 mother's father's father's mother)
(D 11 mother's father's mother's father) (D 12 mother's father's mother's mother)
(D 13 mother's mother's father's father) (D 14 mother's mother's father's mother)
(D 15 mother's mother's mother's father) (D 16 mother's mother's mother's mother)

March 1875

ODD numbers indicate males (fathers, grandfathers, &c.)
EVEN " " females (mothers, grandmothers, &c.)

A = Father (A 1) and Mother (A 2)

B = { Grandfathers (B 1 father's father)
and (B 3 mother's father)
Grandmothers (B 2 father's mother)
(B 4 mother's mother)

C = {
 Great-grandfathers (C1 father's father's father)
 (C3 father's mother's father)
 and (C5 father's father's father)
 (C7 mother's mother's father)
 Great-grandmothers. (C2 father's father's mother)
 (C4 father's mother's mother)
 (C6 mother's father's mother)
 (C8 mother's mother's mother)

	Great-grand-fathers	and	Great-grand-mothers
D =	(D1 father's father's father's father)		(D2 father's father's mother's mother)
	(D3 father's father's mother's father)		(D4 father's father's mother's mother)
	(D5 father's mother's father's father)		(D6 father's mother's father's mother)
	(D7 father's mother's mother's father)		(D8 father's mother's mother's mother)
	(D9 mother's father's father's father)		(D10 mother's father's father's mother)
	(D11 mother's father's mother's father)		(D12 mother's father's mother's mother)
	(D13 mother's mother's father's father)		(D14 mother's mother's father's mother)
	(D15 mother's mother's mother's father)		(D16 mother's mother's mother's mother)

ANCESTORS OF

E6. <i>Thkhäppin</i>		D3		D4		D5		D6	
!Bəgəhəu or !kən thi (youthful name)		!nə-ā' Tā (farrowhead) or !nə būwā'ti (youthful name)		!ā' Wi'tān					
D2		C2 !aun-ān' or !kə'ra'kən (youthful name)		!kū'n (youthful name) or C3 !kə'tā'kū'n				D7	
D1		C1		B1 !kə'kə'kə' or !kə'te or !kə'te		B2 !kə'te'kə' or !kə'te'kə'		D8	
D16		C8		A1 !kū'n or !kə'te or !kə'te		A2 !kū'n or !kə'te or !kə'te		D9	
!kə'ā'ā'ā'		!kə'-ān'		!kə'ā'ā'ā'		!kə'ā'ā'ā'		D10	
D15		C7		!kə'ā'ā'ā' or !kə'ā'ā'ā'		!kə'ā'ā'ā' or !kə'ā'ā'ā'		D11	
D14		D13		D12		D11		D10	

Odd numbers indicate males (fathers, grandfathers, etc.)
Even " " females (mothers, grandmothers, etc.)

A = Father (A 1) and Mother (A 2)

B = { Grandfathers (B 1 father's father)
and (B 2 mother's father)
Grandmothers (B 3 father's mother)
(B 4 mother's mother)

C = { Great-grandfathers (C 1 father's father's father)
and (C 2 father's mother's father)
(C 3 father's father's father)
(C 4 mother's mother's father)
Great-grandmothers (C 5 father's father's mother)
(C 6 mother's mother's mother)
(C 7 mother's mother's father)
(C 8 mother's mother's mother)

D = { Great-great-grandfathers (D 1 father's father's father's father)
and (D 2 father's father's father's mother)
(D 3 father's father's mother's father)
(D 4 father's father's mother's mother)
(D 5 father's mother's father's father)
(D 6 father's mother's father's mother)
(D 7 father's mother's mother's father)
(D 8 father's mother's mother's mother)
(D 9 mother's father's father's father)
(D 10 mother's father's father's mother)
(D 11 mother's father's mother's father)
(D 12 mother's father's mother's mother)
(D 13 mother's mother's father's father)
(D 14 mother's mother's father's mother)
(D 15 mother's mother's mother's father)
(D 16 mother's mother's mother's mother)

BC 151 E1 2.6.34

BLEEK

Bushman Genealogies

~~BCA 151 (1, 1a-33)~~

*catalogued fully by Spink July 1883.
[see also Bleek: Beldanda]*

Stammbaum der Primaten Ordnung.

(am liebsten nach Herrn Professor Naeske, siehe Seite 2. d. Thesen)

